

Instructions

Installation conversion kit SA valve – MP 1/2“ Pulsar III Art.Nr. 27350D

Clemco
International GmbH

Carl-Zeiss-Straße 21
83052 Bruckmühl
Germany

Tel.: +49 (0) 8062 – 90080
Mail: info@clemco.de
Web: www.clemco-international.com

1 Scope of application

These conversion instructions apply to the replacement of metering valves type SA with metering valves type Quantum for the following cabins:

<i>Cabin</i>	<i>Art.Nr.</i>
Pulsar III Pressure	100056

Table 1: Scope of application

In addition, the following operating instructions must be observed:





- Operating instructions of the dosing valve MP ½"

2 Particular hazards

Observe the safety instructions listed here in order to reduce health hazards and avoid dangerous situations.

	Warning
	<p>Risk of injury from pneumatic energies! Pneumatic energies can cause extremely serious injuries. Loose screw connections can cause components to come loose and fly away at high speed. If individual components are damaged, air can escape under high pressure and damage the eyes, for example. Therefore:</p> <ul style="list-style-type: none"> - Only work on the depressurised system. - Disconnect the system from the compressed air supply before working on it. - Before commissioning, check that the screw connections are in perfect condition.

3 Scope of supply:

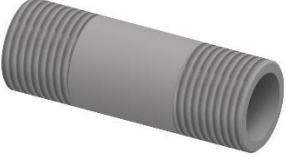
<p>Dosing valve MP 1/2" pre-assembled</p>	
<p>Air hose Art:Nr. 27293D 0,4 m</p>	
<p>Hose nipple Art:Nr. 27291D</p>	
<p>Clamp Art:Nr. 27292D 4 Stk</p>	
<p>Pipe 1/2" l=60 Art:Nr. 90308D</p>	

4 Assembly procedure

4.1 Removal of existing parts

1. Uncouple blasting hose.
2. Loosen the screw connections of the connecting line between the blast pot and the dosing valve.
3. Remove pipe.

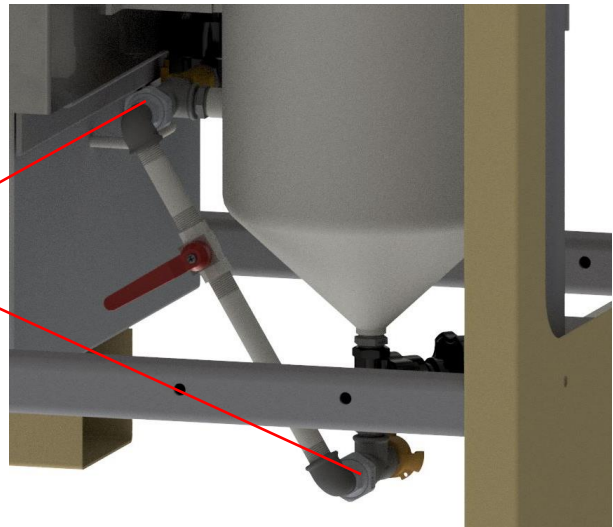

4. Remove hose coupling with double nipple

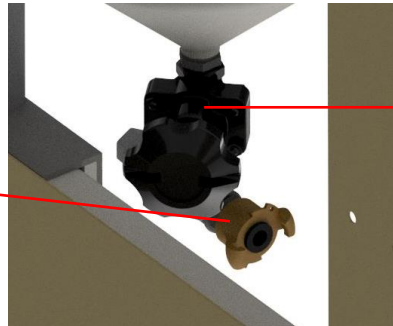

5. Remove dosing valve. Double nipple on the blast pot remains mounted

4.2 Installation of dosing valve

1. Screw the dosing valve into the blast pot. Hose connection piece should be aligned in the direction of the cabin.

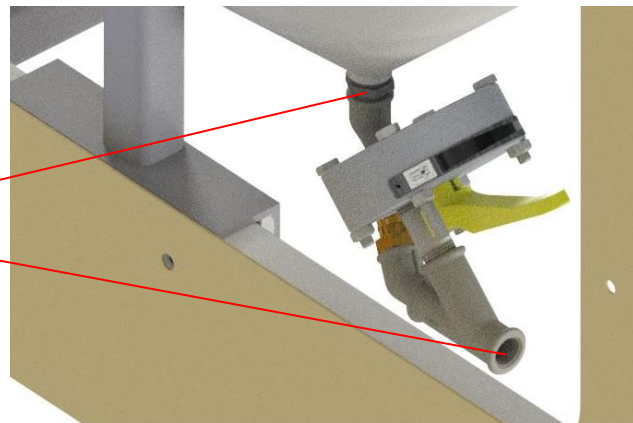

2. Refit the hose coupling

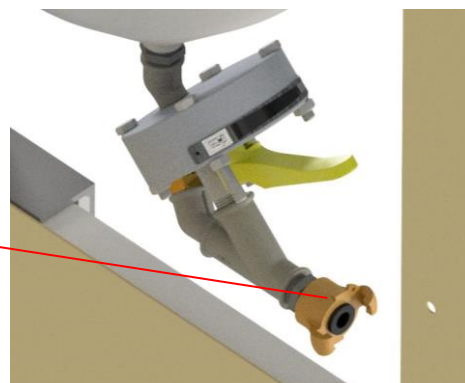

4.3 Ball valve assembly

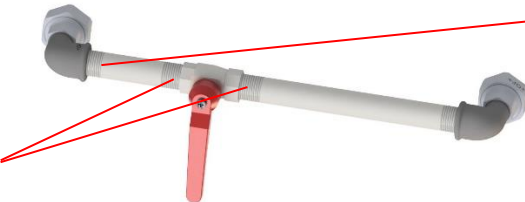
1. Detach the ball valve from the old pipework.
 2. Remove the short pipe from the elbow
- 

3. Screw the hose nipple and the pipe into the ball valve.
Use thread sealant (Teflon tape; liquid sealant).
Hand-tighten the pipe socket and then tighten it further with the tool by 2 - 3 turns.

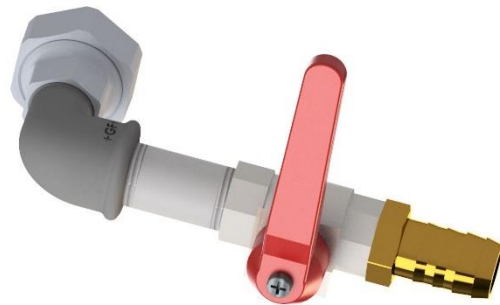

4. Install the assembled ball valve in the elbow

5. Mount the ball valve again in the old position.

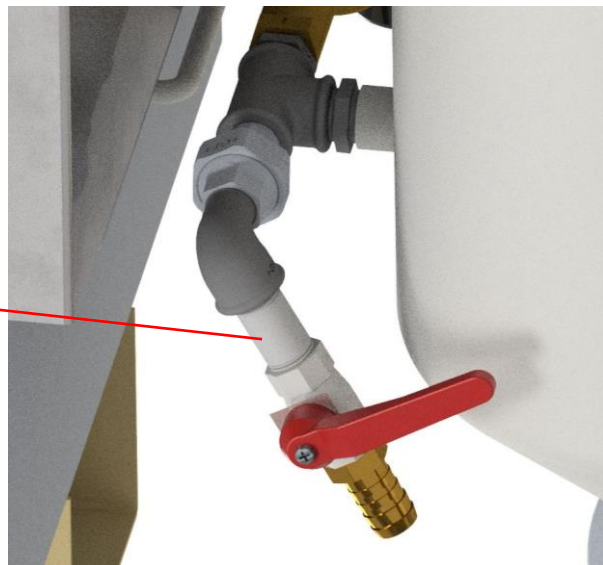

4.4 Mounting the connection hose

1. Slide the hose clamps onto the hose.



2. Adapt hose length to pipework.

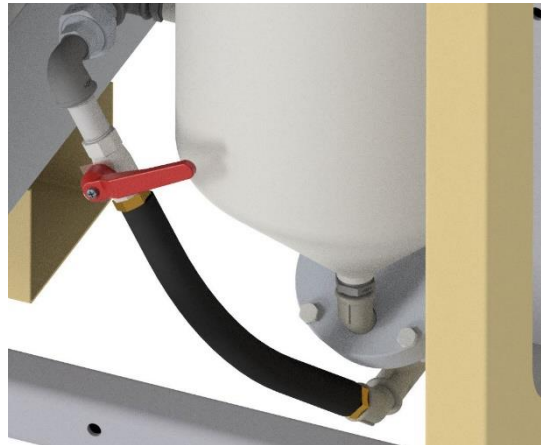

3. Push the hose onto the hose nipples
For easier assembly, spray the hose nipple with silicone spray before assembly.

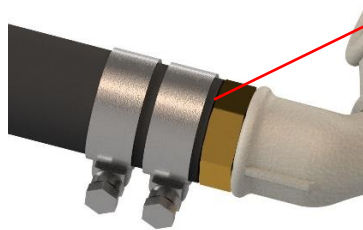

Hose must be pushed up to the collar of the hose nipple.

4. Tighten the hose clamps.

5 Restart

- Before putting the blast pot back into operation, check all screw connections for tightness.
- Carry out a function test without blasting media. Check all connections for leaks.
- Only fill in blasting media and adjust the dosage after the leak test has been carried out.